

Oliver Creek Calls

LINE	BEARING	DISTANCE
L1	N40°35'20"W	238.90'
L2	N59°40'21"W	118.26'
L3	N83°06'23"W	81.10'
L4	S84°58'57"W	83.88'

Basis of Bearings is NAD83 Grid Bearings NCTZ and Distances reflect Surface Measurements

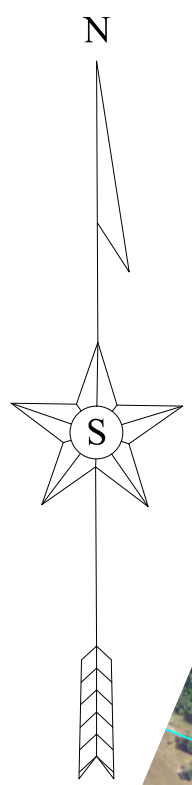

THE SURVEYOR HAS MADE NO INVESTIGATION OR INDEPENDENT SEARCH FOR LEASE LINES, EASEMENTS OF RECORD, ENCUMBRANCES, RESTRICTIVE COVENANTS, OWNERSHIP TITLE EVIDENCE, OR ANY OTHER FACTS THAT A CURRENT TITLE SEARCH MAY DISCLOSE.

- LEGEND**
- FIP = Found Rebar
 - WFCP = Wood Fence
 - corner post
 - PFPCP = Pipe Fence
 - corner post
 - SIP = Set 1/2 inch
 - Rebar
 - POB = Point of Beginning
 - = Fence
 - = Property line
 - = Elec. Line
 - = Survey Line

FOR METES AND BOUNDS DESCRIPTIONS SEE ACCOMPANYING DOCUMENTS.

The undersigned does hereby state that Glen and Louise Shoop Family Partnership, Ltd. the map or plat is based upon an on the ground survey, and that the plat conforms to or exceeds the current Minimum Standards for Professional Land Surveys as adopted by the Texas Board of Professional Land Surveying and said property has access to a roadway unless otherwise noted.

This Plat and description was prepared for the exclusive use of the person or persons named in the above statements. Said statement does not extend to any unnamed person without an express restating by the surveyor named said person. This survey was prepared for the transaction as dated hereon, and IS NOT to be used in any other transactions, and the copyrights are reserved.



ERIC BRENNAN, TEXAS REGISTERED PROFESSIONAL LAND SURVEYOR NUMBER 5560

Client: Shoop Family Partnership
 Boundary Survey of 1807.46 acres in the
 I. Davis Survey, Abstract Number 247
 the J. Beebe Survey, Abstract Number 56
 and the J. C. Bateman Survey, Abstract Number 1154
 in the County of Wise, State of Texas
 T. Samuel Survey, A-757 Wise Co. A-1148 Denton Co and
 Smith County School Land Survey, A-744 Wise Co. A-1725 Denton Co
 J. Brumley Survey, Abstract Number 1581
 the M.E.P. & P. Railroad Survey, Abstract Number 914,
 the W. Chambers Survey, Abstract Number 1520,
 and the A. Pulen Survey, Abstract Number 1057,
 in the County of Denton, State of Texas

NOTES:
 Adjoining tract data is for informational purposes only and does not represent a complete survey of those lands. Possible conflicts in adjoining property lines may arise from a current survey of those parcels. This plat represents a survey of the boundaries of the parcels cited in request for survey.
 THE SURVEYOR HAS MADE NO INVESTIGATION OR INDEPENDENT SEARCH FOR LEASE LINES, EASEMENTS OF RECORD, ENCUMBRANCES, RESTRICTIVE COVENANTS, OWNERSHIP TITLE EVIDENCE, OR ANY OTHER FACTS THAT A CURRENT TITLE SEARCH MAY DISCLOSE.

OWEN SURVEYING CO.
 FIRM #11069000 WWW.OWENSURVEYING.COM
 110 W. ELLIOTT ST., BRECKENRIDGE, TX 76424
 PHONE (254)559-9898 FAX (254)559-7372 CELL (254)559-0127

BOUNDARY PLAT: WISE AND DENTON COUNTIES
 DRAWN BY: EB CHECKED BY: EB
 Scale 1"=600' Date 19 May 2014 Print Number DE-725B West Owen Surveying Co., Copyrights Reserved 2014